

**4 LIGHTING BASE** 1'-1'-0"

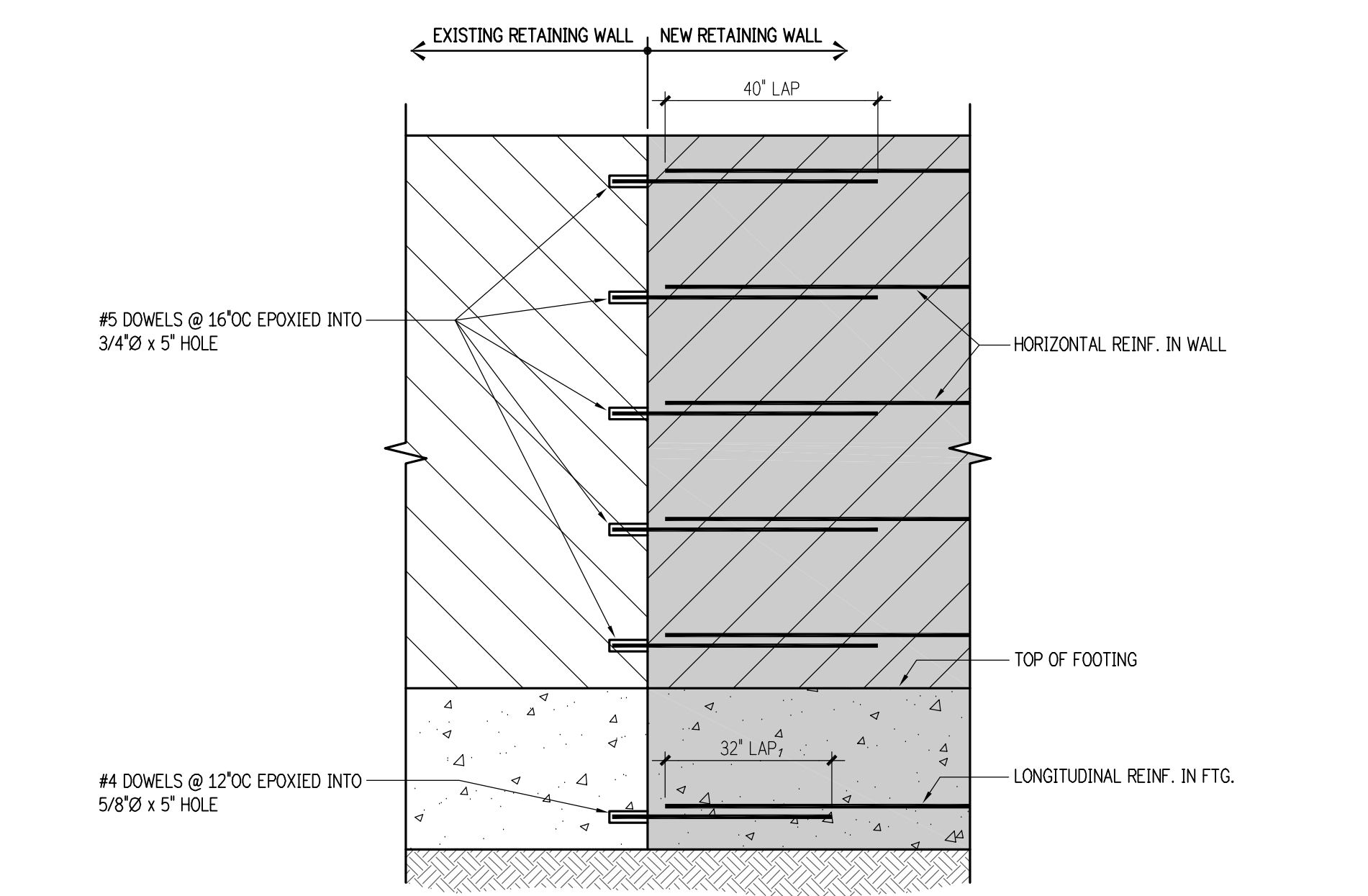

**5 NEW WALL/FTG. TO EXISTING WALL/FTG.** 1'-1'-0"

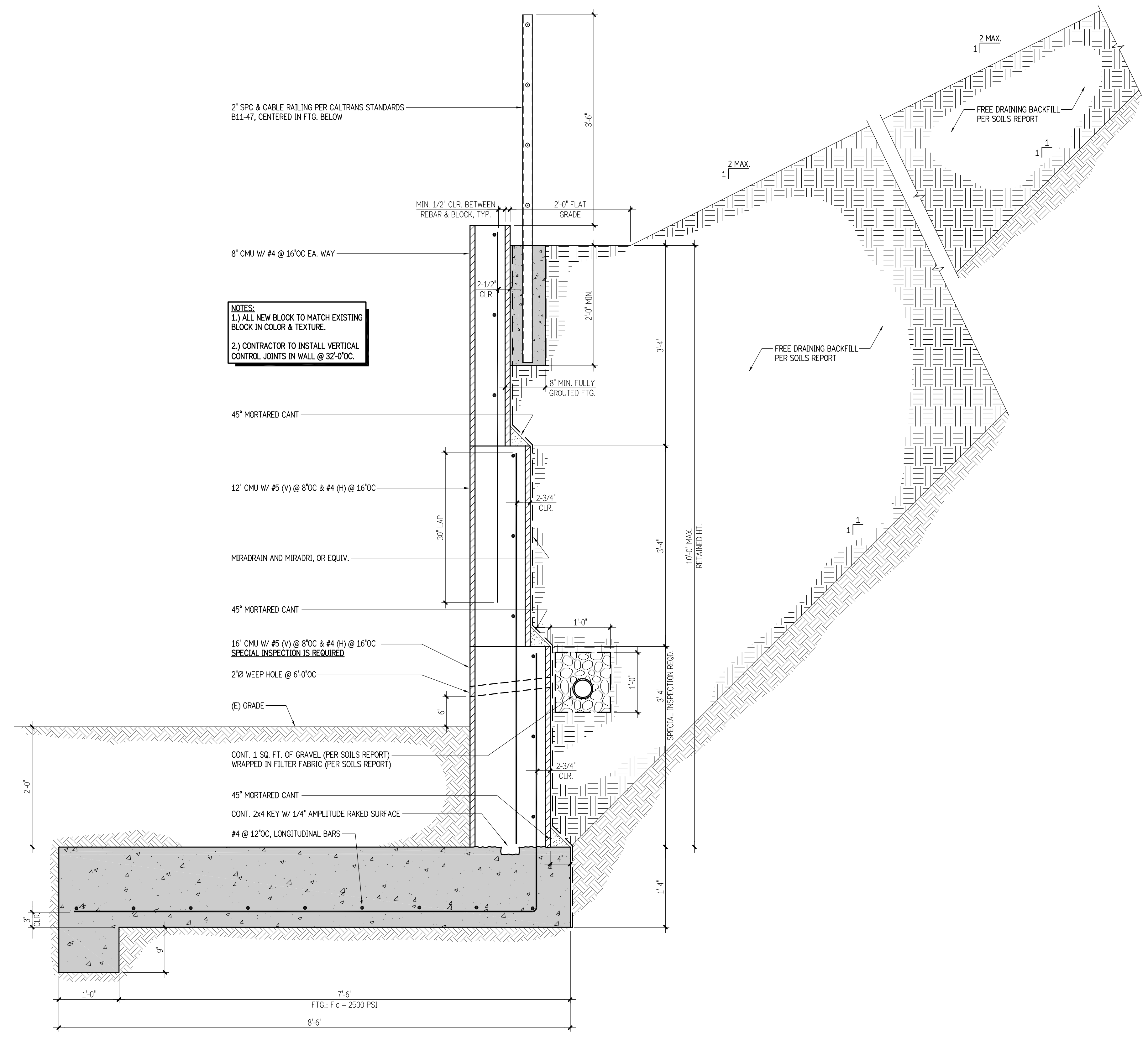

**3 10'-0" RETAINING WALL** 1'-1'-0"

**60% SUBMITTAL**

**S2.2**

THIS DRAWING IS PROVIDED IN AN ELECTRONIC FORMAT AS A COURTESY IF REQUESTED BY THE USER. THE DELIVERY OF THE ELECTRONIC FILE DOES NOT CONSTITUTE THE DELIVERY OF OUR PROFESSIONAL WORK PRODUCT. THE SIGNED HARD COPY PREPARED FOR THE PROJECT CONSTITUTES OUR PROFESSIONAL WORK PRODUCT AND THE HARD COPY MUST BE REFERRED TO FOR THE CORRECT DESIGN INFORMATION. WE SHALL NOT BE RESPONSIBLE FOR ANY MODIFICATIONS MADE TO THE FILE, OR FOR ANY PRODUCTS DERIVED FROM THE ELECTRONIC FILE WHICH ARE NOT REVIEWED, SIGNED AND SEALED BY FLOWERS & ASSOCIATES, INC. (F&A). USER AGREES TO INDEMNIFY AND HOLD HARMLESS F&A FOR ALL COSTS AND DAMAGES IF USED.

THESE PLANS HAVE BEEN PREPARED SOLELY FOR USE FOR THE PROJECT SCOPE AND SITE SPECIFICALLY IDENTIFIED HEREON AT THE TIME THESE PLANS ARE SIGNED. THE ENGINEER PREPARING THESE PLANS WILL NOT BE RESPONSIBLE FOR, OR LIABLE FOR, USE OF ANY PART OF THESE PLANS, INCLUDING ANY NOTE OR DETAIL, FOR ANY UNAPPROVED OR REVISED PROJECT SCOPE, OR FOR ANY OTHER PROJECT AT THIS OR ANY OTHER SITE.

REV.	SYMBOL	DESCRIPTION OF CHANGE	R.C.E.	DATE	P.D.E.	DATE

DATE:  
AHC / ELF  
DESIGNED

DATE:  
SIS  
DELINEATED

DATE:  
ELF  
CHECKED



**D** Doyle-Morgan  
Structural Engineering  
1900 State Street, Suite K  
Santa Barbara, CA 93101  
Ph: (805) 569-1134 - Fax: (805) 569-1554  
E-mail: doyle.morgan@verizon.net

**M** PRELIMINARY - NOT FOR  
CONSTRUCTION  
REGISTERED ENGINEER 02/02/2011  
DATE

CITY OF THOUSAND OAKS

PROJECT ENGINEER DATE

ENGINEERING DIVISION MANAGER DATE

**CITY OF THOUSAND OAKS**  
**TRANSIT CENTER PARKING LOT EXPANSION**

CITY OF THOUSAND OAKS DWG. 00-00000 .

SHT. \_\_\_\_ OF \_\_\_\_